

Big Sky Planning Packet



Camp ToknowHim

PO Box 190, Pisgah, AL 35765 256-451-7777

Map of Camp ToknowHim

Founder's Retreat

1
 2
 Founder's House
 Kitchen
 Assembly
 Dining
 Soccer field

Big Sky Retreat

NEMA 14-50
 Amphitheater
 County Road 88
 Parking
 Eagle
 Kitchen
 Assembly
 Soccer field
 Dove
 Falcon
 Osprey

Woodlands Retreat

Pilgrim's Rest
 Tranquility
 Stage
 Soccer field
 Gym
 Assembly
 Kitchen
 Parking
 NEMA 14-50
 Whippoorwill
 Trail to Low Ropes Course
 Bus drop-off

Lake

Pavilion
 Pavilion
 1-mile walking loop

LEGEND	
	Roads
	Walking Trails
	Private Drive

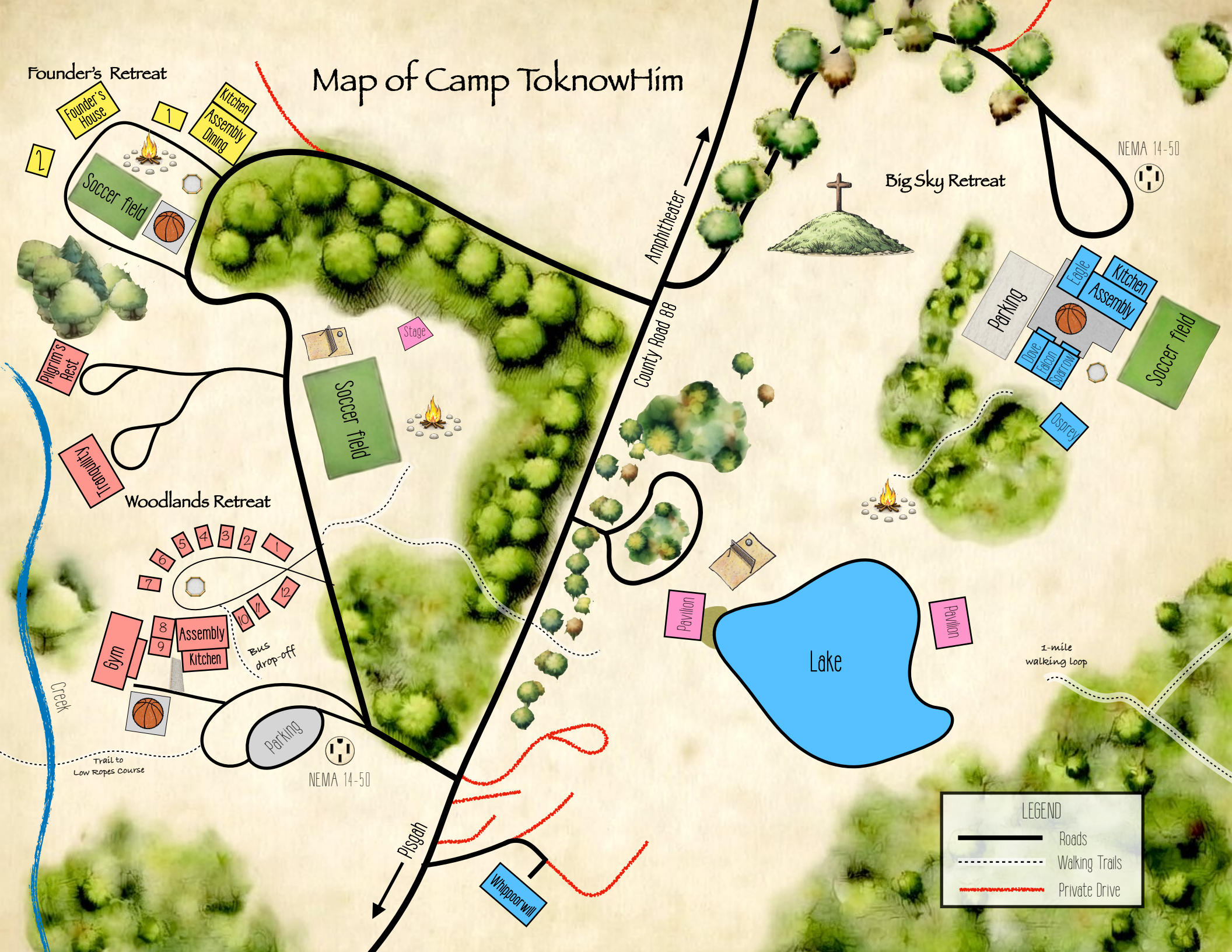

SMALL GROUP FACILITY POTENTIAL BEDS PER CABIN/BUILDING

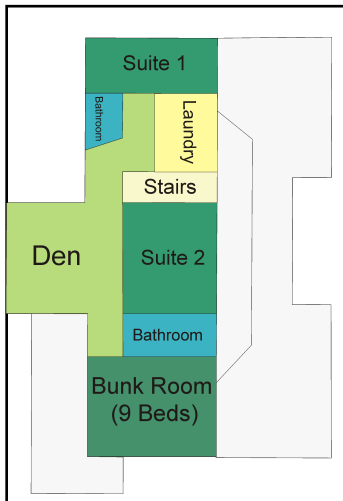

Upstairs

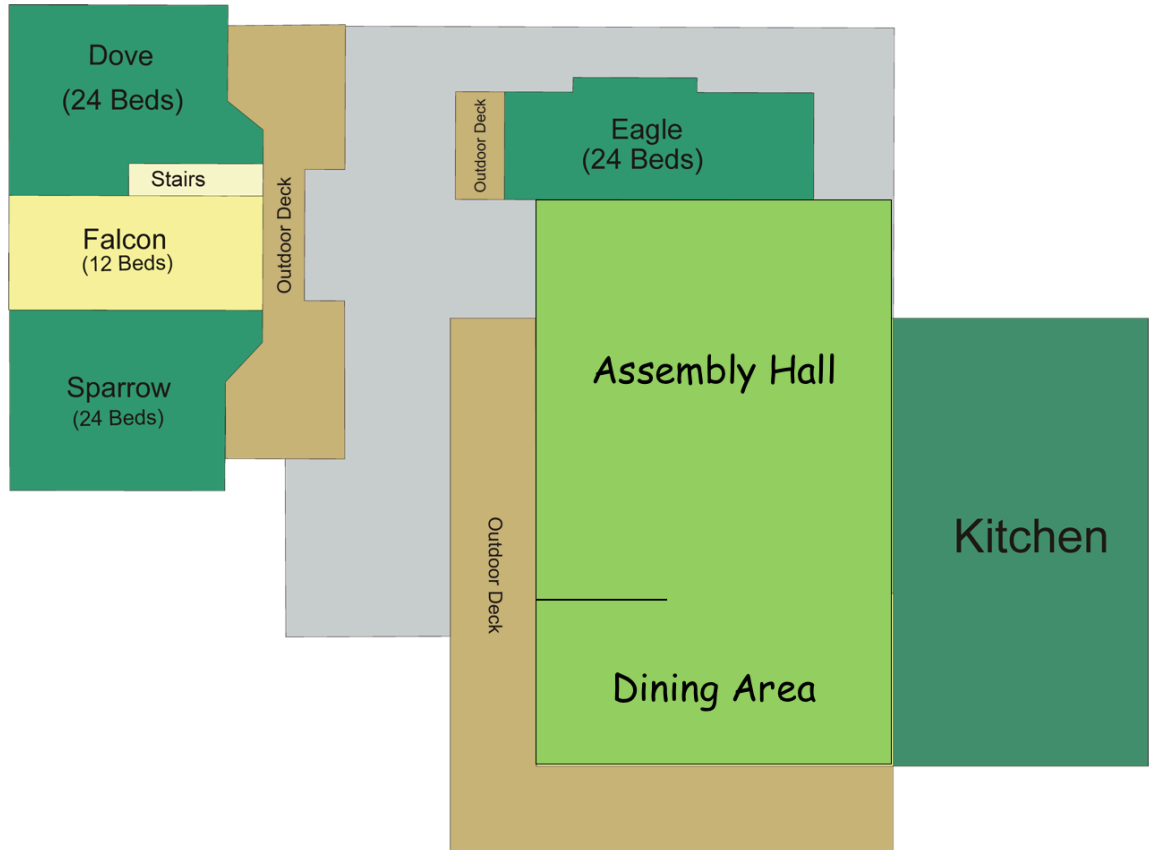

Cots
(available if needed)



Suite 1



Suite 2



Cabin Bunks

CABIN	IN BUNK BEDS	ON COTS	TOTAL CAMPERS
Dove	24	6	30
Sparrow	24	6	30
Falcon	12	2	14
Eagle	24	0	28
Osprey	26	6	32
Suite 1	4 (1 Queen, 2 Singles)	0	4
Suite 2	2 (1 King)	2	4
Upstairs Bunk Room	9	0	13
TOTALS	125	22	151

LEADERS

WHIPPOORWILL has three bedrooms for sleeping arrangements: one downstairs and two connecting bedrooms in the loft. It is often used for leaders, cooks, or the band. It is fully furnished and bedding/linens are provided.



Did you know?
When not used by groups at the camp, we make Whippoorwill available as a reprieve for those in full-time ministry or for other ministry purposes.



WATERFRONT RULES

- EACH GROUP MUST PROVIDE 4 ADULTS FOR SUPERVISION. 2 IN THE LIFEGUARD STANDS, 1 ON THE FLOATING DOCK AND 1 AT THE ROPE SWING
- NO SWIMMERS MAY ENTER THE WATER UNTIL ALL ADULTS ARE IN THEIR STATIONS
- ALL SWIMMERS OUTSIDE SWIM AREA MUST WEAR LIFE JACKETS
- ALL SWIMMERS MUST STAY WITHIN ROPED SWIMMING AREA (UNLESS USING ICEBERG OR ROPE SWING)
- NO DIVING OFF DOCKS OR ICEBERG

ROPE SWING USE

- LIFE JACKETS REQUIRED
- NO MORE THAN 3 PARTICIPANTS ON TOP LEVEL OF DOCK AT A TIME
- ONLY SWING STRAIGHT OFF OF THE PLATFORM
- PARTICIPANTS WAITING FOR THEIR TURN MUST REMAIN ON THE LOWEST PORTION OF THE DOCK TO PREVENT INJURY FROM THE RETRIEVAL STICK

ICEBERG USE

- LIFE JACKETS ARE REQUIRED
- NO MORE THAN 6 PEOPLE USING ICEBERG SWIM AREA AT A TIME
- ONLY 2 PEOPLE CLIMBING ON ICEBERG AT A TIME TO PREVENT IT FROM TIPPING OR RIPPING
- ONLY JUMP OR SLIDE OFF SIDE WITH NO HANDLES
- AFTER JUMP OR SLIDE, SWIM IMMEDIATELY OUT OF THE WAY

KAYAK USE

- LIFE JACKETS REQUIRED
- RETURN KAYAKS NEATLY TO THE DESIGNATED AREA





Camp ToKnowHim

Scheduling and Activities

Lake Use (Summer Months)

- The Woodlands
 - 3-6pm
- Big Sky
 - 12-3pm

Low Elements Ropes Course

- The Woodlands
 - 12-3pm
- Big Sky
 - 3-6pm

Amphitheater

Our amphitheater is located 2 miles down a gravel road that is located just 1 mile west down Co. Rd. 88. After scheduling use of Amphitheater, please indicate what method(s) of transportation you would like to use for your group:

- Transport your group in personal vehicles (SUV's, trucks, and some buses are acceptable, cars not recommended)
- Arrange for us to transport your group with our 5 ton military truck and/or bus (make sure to check availability and schedule ahead of time)

**** Refer to map and see location of Amphitheater**

Fishing

For individuals who would like to enjoy some fishing in their free time, there are 2 ponds available with a variety of fish. Please refer to map for location.



KITCHEN GUIDE

— Everything you need to know for your stay —



— Serving Line —



— Cooking Supplies —

Kitchen Equipment

- 2 Residential Stove/Ovens
- 2 Microwave Ovens
- 3 Residential All Refrigerators
- Upright Freezer
- Commercial Coffee/Tea Maker
- 2 Coffee Airpots
- 1 Tea Dispenser
- Ice Machine
- Pots, Pans & Utensils
- Electric Griddles
- Electric Skillets
- Crock Pots
- 2 Five-Gallon Drink Coolers
- 2 Toasters
- Electric Mixer
- Dish Towels & Pot Holders
- Large Gas Grill (Propane Provided)

If You Are Cooking Your own Meals

The camp does NOT provide:

- Food
- Drinks
- Cups
- Plates
- Plastic Ware
- Napkins
- Plastic Wrap / Aluminum Foil
- Coffee/Creamer/Sugar/Sweeteners

The Camp Provides

- Trash Bags
- Coffee Filters
- Shower Soap
- HandSoap
- DishSoap
- Paper Towels
- Toilet Paper
- Cleaning Products

Catering Menu

Catered meals are available, and the food is delicious! Current pricing can be found on the downloads page of our website under "catering contract". If you are interested in having your meals catered, please contact Michelle Powell directly.

Michelle Powell 256-557-0769

Breakfast Options

All Breakfasts are served with Coffee, Juice, Milk, Fruit and Cereal

- Biscuits and Sausage Gravy with Eggs
- Pancakes with toppings of choice and Sausage
- Breakfast Casserole with Muffins and Yogurt
- French Toast with Toppings of choice and Bacon
- Sausage Biscuits and Bacon Biscuits with Hash Browns
- Eggs with Bacon and Toast

Lunch Options

All Lunches are served with Tea, Kool-aid, and Dessert

- Hotdogs and Hamburgers, Chips and Baked Beans
- Taco Salad with Toppings
- Pizza and Salad
- Sub sandwiches with Chips and Home Style Chicken Soup
- Barbecue Sandwiches with Potato Salad or Chips and Coleslaw

Dinner Options

All Dinners are served with rolls or cornbread, Dessert, Tea and Kool-aid

- Chicken Fingers with Mashed Potatoes, Green Beans and Mac and Cheese
- Spaghetti with Salad and Garlic Bread
- Baked Ham with Scalloped Potatoes, Peas and Corn
- Creamy Oven Chicken with Roasted Potatoes and Mixed Vegetables
- Pork Loin with Mushroom Gravy , Roasted Potatoes and Black Eyed Peas
- Roast Beef or Cajun Roast Beef with Carrots and Potatoes
- Grilled Chicken with Party Potatoes and Green Beans

Sound Equipment



Behringer x32 Digital Sound Board



2 Mackie SR1530 Powered Speakers
2 JBL Eon Power15 Monitors



4 Shure SM58 Microphones
High Definition Projector
Microphone Stands
2 Direct Boxes
Guitar Stands
1/4" Cables
XLR Cables
Built in snake cables
Wireless Internet